

# Hopper system BBH

## Characteristics

The hopper system of type BBH prolongs the autonomy of the feeding system decisively and also reduces its susceptibility to failure. It



is characterized by its space-saving structure, whereby filling weights of up to 500 kg can be transported. Combination options with pre- or

post-connected hopper systems as well as tilting devices for wire mesh boxes or large containers are possible.

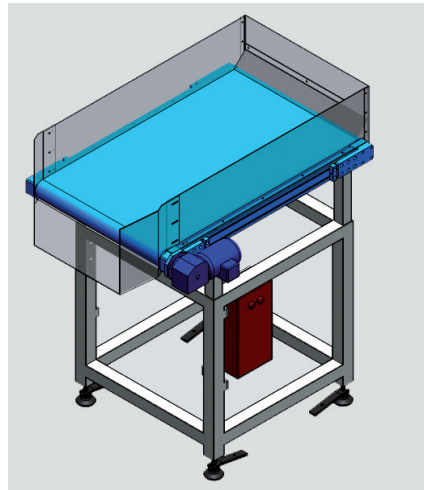
## Structure



Color scheme of the individual components:

-  Motor
-  Hopper control
-  Conveyor belt

## Technical data

Device type	BBH40-80	BBH80-180
max. filling volume [l]	80	180
max. filling weight [kg]	75	500
Protection class in accordance with DIN EN 60529	IP 54	IP 54
Article no.	1-001597	1-000386

## Dimensions

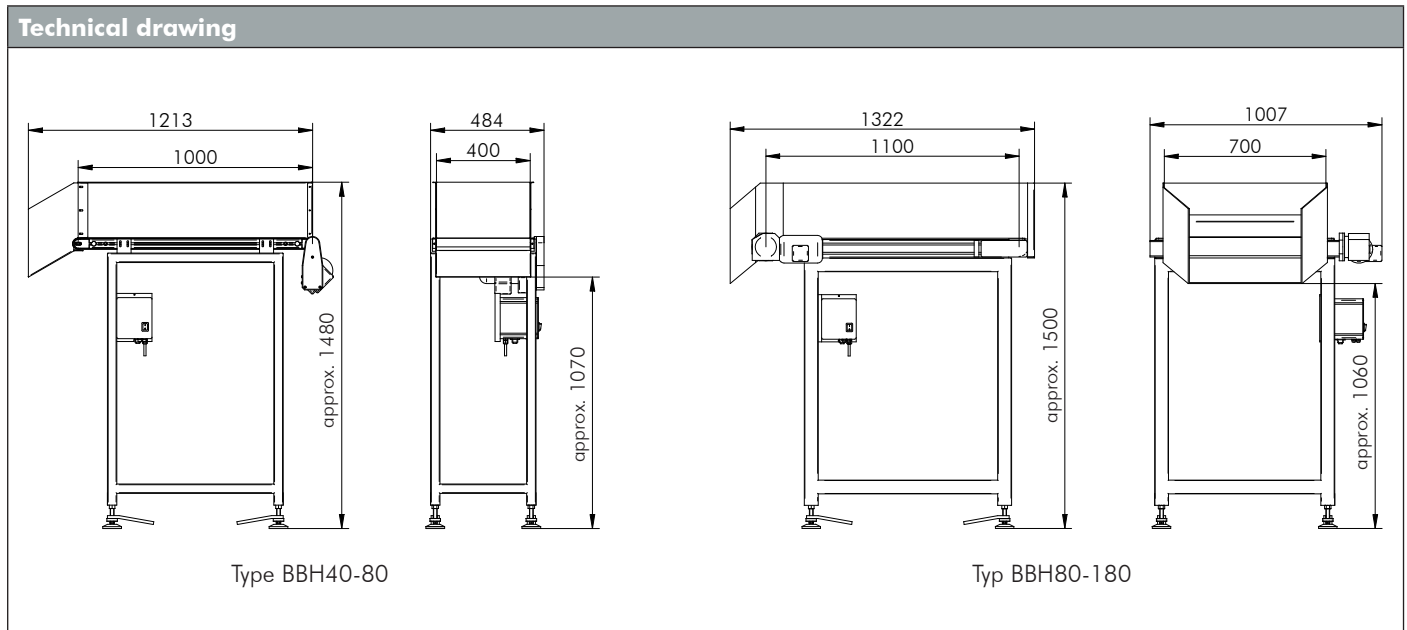

## Accessories

Designation	Description	Article no.
<b>Hopper control BS5</b>	Hopper control BS5 for belt hopper of type BSF-1, BBH, BBR, BBV	2-009382
<b>Pendulum switch PS1</b>	Pendulum switch PS1 for automated filling level control of bulk material in the sorting device, compact design, optical status display via LED, inductive switch without wear	2-002099
<b>Filling level query</b>	Filling level query in the bulk hopper with light barrier divided into two parts	–
<b>Container depot / platform</b>	–	–